

NOTES:

1. HEIGHTS AND LATERAL DISTANCES ESTABLISHED VIA FIELD MEASUREMENTS.
2. THE SECTION SHOWN IS A GENERAL REPRESENTATION OF THE AREA.
3. HIGH-LEVEL AERIAL PHOTOGRAPHY AND GIS DATA WAS UTILIZED FOR VERIFICATION AND CROSS-REFERENCING OF FIELD MEASUREMENTS.

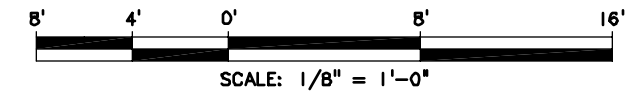

Approved:	K.E.B.	Date:	10-28-09
Scale:	1/8" = 1'-0"	Contract No.:	RH100212JB
Filename:		Date:	10-29-09

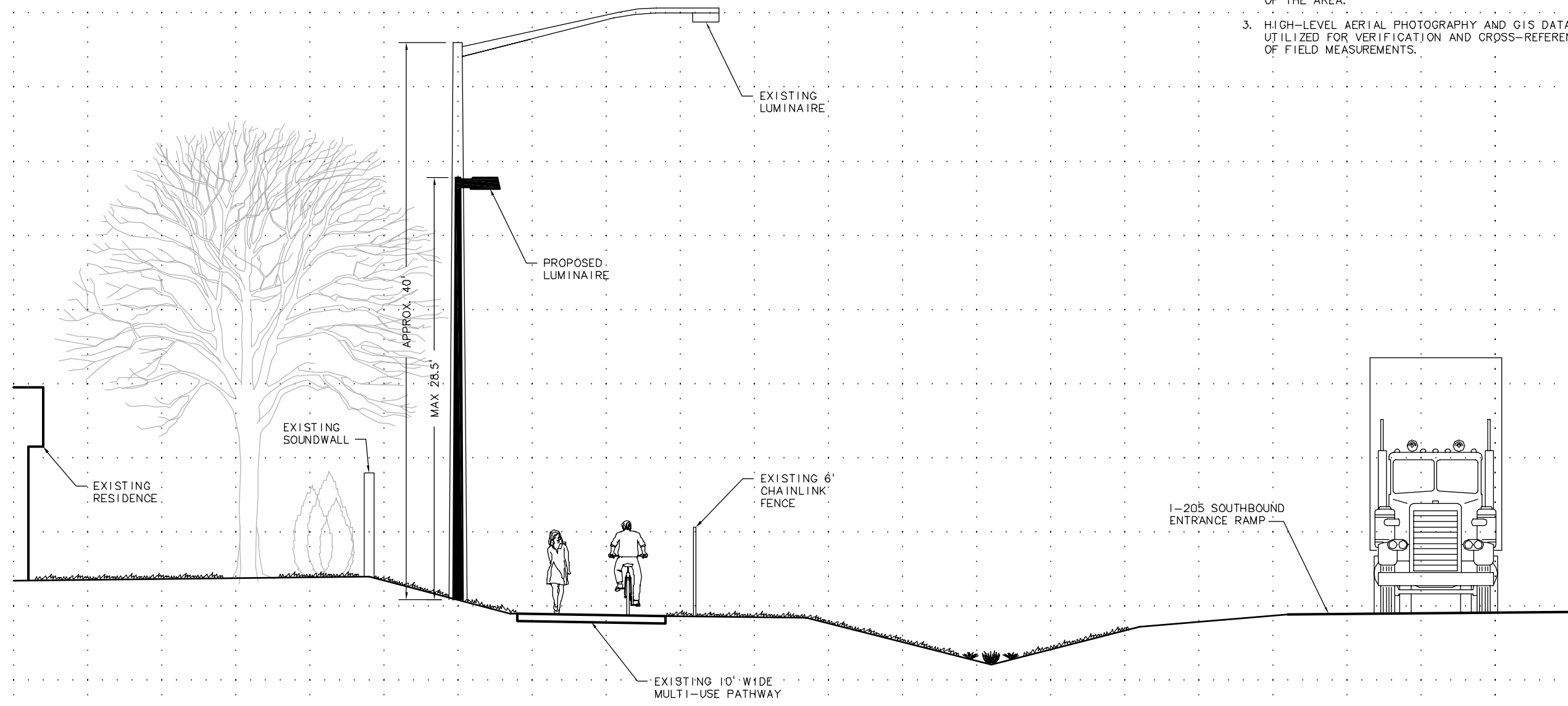

TRI-COUNTY METROPOLITAN TRANSPORTATION DISTRICT OF OREGON

URS

111 SW Columbia, Suite 1500
Portland, Oregon 97201-5850
(tel) 503-222-7200
(fax) 503-222-4292
www.urscorp.com

TRI MET

CAPITAL PROJECTS AND FACILITIES DIVISION
710 N.E. HOLLADAY STREET
PORTLAND, OREGON 97232

CROSS-SECTION F		Drawing No.:	Rev.:
		Sheet No.:	2 OF 4

S:\public\elliott\I-205 cross sections\ALL SECTIONS.dwg, 10/29/2009 10:34:49 AM, Robin_Elliott